

STATE OF NORTH CAROLINA
DIVISION OF HIGHWAYS

STATE	STATE PROJECT REFERENCE NO.	HEET NO.	TOTAL SHEETS
N.C.	11C.003083	1	06

YADKIN COUNTY

**LOCATION: SR 1195 KING RD. FROM THE INTERSECTION
OF SR 1103 "MARLER RD." STA. 10+00 TO END OF PROJECT
STA. 29+04.35**

TYPE OF WORK: GRADE, DRAIN, BASE, PAVE - 0.36 MILES

BEGIN PROJECT
Sta. 10+00.00

END PROJECT
Sta. 29+04.35

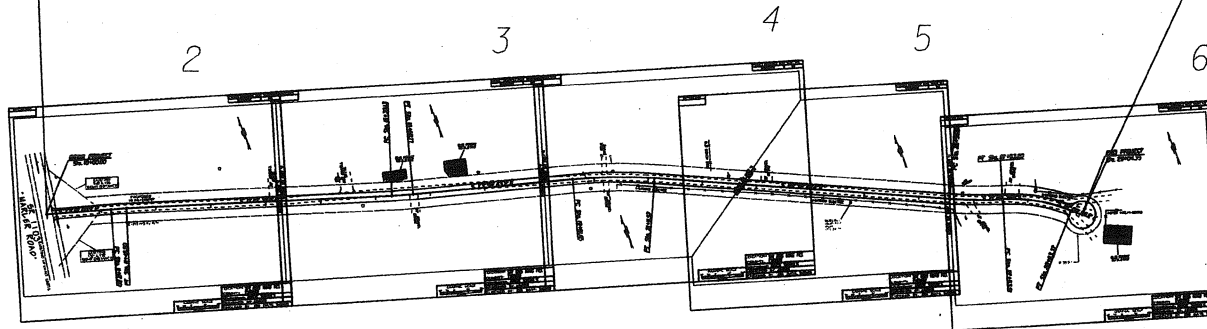

THESE EROSION AND SEDIMENT CONTROL PLANS COMPLY WITH THE REGULATIONS SET FORTH BY THE NCG1000 GENERAL CONSTRUCTION PERMIT EFFECTIVE AUGUST 3, 2011 ISSUED BY THE NORTH CAROLINA DEPARTMENT OF ENVIRONMENT AND NATURAL RESOURCES DIVISION OF WATER QUALITY

SITE DESCRIPTION	STABILIZATION	TIMEFRAME EXCEPTIONS
PERIMETER DIKES, SWALES, DITCHES AND SLOPES	7 DAYS	NONE
HIGH QUALITY WATER ZONES	7 DAYS	NONE
SLOPES STEEPER THAN 3:1	7 DAYS	IF SLOPES ARE 10' OR LESS IN LENGTH AND ARE NOT STEEPER THAN 2:1, 14 DAYS ARE ALLOWED
SLOPES 3:1 OR FLATTER	14 DAYS	7 DAYS FOR SLOPES GREATER THAN 20' IN LENGTH
ALL OTHER AREAS FLATTER THAN 4:1	14 DAYS	NONE, EXCEPT FOR PERIMETERS AND HQW ZONES

DISCLAIMER

THIS MAP IS NOT A CERTIFIED SURVEY AND HAS NOT BEEN REVIEWED BY A LOCAL GOVERNMENT AGENCY FOR COMPLIANCE WITH ANY APPLICABLE LAND DEVELOPMENT REGULATIONS. THE PROPERTY SHOWN ON THIS MAP WAS LOCATED FOR THE NORTH CAROLINA DEPARTMENT OF TRANSPORTATION FOR HIGHWAY DESIGN PURPOSES. SOME ERROR MAY EXIST BETWEEN THE GRAPHICAL AND ACTUAL GROUND LOCATIONS OF PROPERTY LINES. THIS MAP IS TO BE USED AS A GRAPHICAL REPRESENTATION OF THE NCDOT'S INTENT TO ACQUIRE PROPERTY FOR RIGHT OF WAY PURPOSES, AND IN NO WAY REPRESENTS AN ACTUAL BOUNDARY SURVEY OF THIS PROPERTY.

GRAPHIC SCALES

DESIGN DATA

PROJECT LENGTH

0.36 MILES

Prepared in the Office of:
DIVISION OF HIGHWAYS
DIVISION 11, DISTRICT 1, ELKIN
P.O. BOX 558 ELKIN, NC 28621

RIGHT OF WAY DATE:
JULY 29, 2009

LETTING DATE:

M.A. PETTYJOHN, P.E.
DIVISION ENGINEER

B.W. WHITAKER, P.E.
DISTRICT ENGINEER

DIVISION ENGINEER

SIGNATURE: _____ P.E.

DISTRICT ENGINEER

SIGNATURE: _____ P.E.

DIVISION OF HIGHWAYS
STATE OF NORTH CAROLINA

STATE DESIGN ENGINEER
P.E.

DEPARTMENT OF TRANSPORTATION
FEDERAL HIGHWAY ADMINISTRATION

APPROVED
DIVISION ADMINISTRATOR
DATE

PI Sta 11+32.15
Δ = 2° 03' 21.2" (RT)
D = 7° 09' 43.1"
L = 28.71'
T = 14.35'
R = 800.00'

MARTHA MOODY
DB 424 PG 365

RONNIE KING ET UX
DB 424 PG 369

WILLIAM & JULI
MILLER
DB 596 PG 952

BRIAN & JESSICA
MILLER
DB 824 PG 380

ALL BASIN'S 10'-20'
IN LENGTH REQUIRE
2 COIR FIBER BAFFLES.
BASIN'S LESS THAN 10'
REQUIRE ONLY 1
DESIGN BY: J. C. BRYANT 669

18" MIN. WATTLE
HEIGHT

BEGIN PROJECT
Sta. 10+00.00

EXISTING
100' X 100'
SIGHT DISTANCE

9 x 3 x 3
ID 2.A

PROPOSED
18' PAVEMENT

1.5 %

PROPOSED
PIPE
15'x20'
Sta. 14+15

15' GRAVEL
DRIVE

S 73° 14' 00.5" F

S 71° 10' 39.4" F

PROPOSED
PIPE
18'x40'
Sta. 10+17

9 x 3 x 3
ID 2.B

POWER POLE
10+37
26.59 RT

EXISTING 50' R/W

1.5 %

EXISTING 18' MAINT. LIMITS

EXISTING
100' X 100'
SIGHT DISTANCE

PC Sta. 11+17.80
PT Sta. 11+46.50

PROPERTY LINE (TYPICAL)

MATCHLINE SEE SHEET #3

LOCATION: SR 1195 KING RD.
COUNTY: YADKIN
TOWNSHIP: BUCK SHOALS
DESIGNED BY: J.D. WOOD
CHECKED BY: CSA DATE: 5/28/09

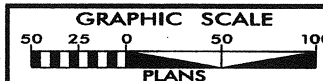

PI Sta 16+49.45
 $\Delta = 2^{\circ} 46' 03.9''$ (LT)
 $D = 7^{\circ} 09' 43.1''$
 $L = 38.64'$
 $T = 19.33'$
 $R = 800.00'$

RONNIE KING ET UX
DB 424 PG 369

WILLIAM & KATIE
KING
DB 424 PG 374

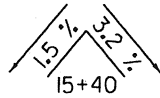

PC Sta. 16+30.13

PT Sta. 16+68.77



PROPERTY LINE (TYPICAL)



22' GRAVEL DRIVE

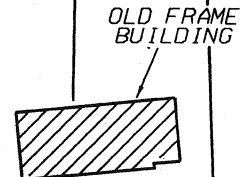

OLD FRAME BUILDING

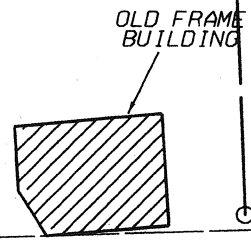

OLD FRAME BUILDING

3.2 %

S 73° 56' 43.2" E

3.2 %

EXISTING PROPERTY IRON STA. 15+76

PROPOSED PIPE 15'x20' Sta. 16+70

15' GRAVEL DRIVE

PROPERTY LINE (TYPICAL)

WILLIAM & JULI MILLER
DB 596 PG 952

WILLIAM MILLER
DB 400 PG 149

18" MIN. WATTLE HEIGHT

ALL BASIN'S 10'-20' IN LENGTH REQUIRE 2 COIR FIBER BAFFLES. BASIN'S LESS THAN 10' REQUIRE ONLY 1
DESIGN BY: J. C. BRYANT 669

MATCHLINE SEE SHEET #2

MATCHLINE SEE SHEET #4

LOCATION: SR 1195 KING RD.
COUNTY: YADKIN
TOWNSHIP: BUCK SHOALS
DESIGNED BY: J.D. WOOD
CHECKED BY: CSA DATE: 5/28/09

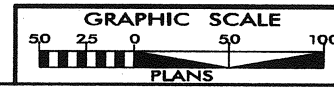

ALL BASIN'S 10'-20'
IN LENGTH REQUIRE
2 COIR FIBER BAFFLES.
BASIN'S LESS THAN 10'
REQUIRE ONLY 1
DESIGN BY: J. C. BRYANT 669

18" MIN. WATTLE
HEIGHT

WILLIAM & KATIE
KING
DB 424 PG 374

WILLIAM & KATIE
KING
DB 424 PG 567

PI Sta 20+36.67
 $\Delta = 9^{\circ}17'54.8''$ (RT)
 $D = 6^{\circ}11'38.9''$
 $L = 150.12'$
 $T = 75.22'$
 $R = 925.00'$

RONNIE KING ET UX
DB 424 PG 369

RONNIE KING ET UX
DB 424 PG 369

PROPOSED
PIPE
18"x40'
Sta.19+87

9 x 3 x 3
ID 4.A

PROPOSED
PIPE
15"x20'
Sta.20+20

EXISTING
PROPERTY
IRON
STA. 20+35

22+50
1.9%
1.8%

EXISTING
PROPERTY
IRON
STA.22+48

EXISTING
PROPERTY
IRON
STA. 22+71

9 x 3 x 3
ID 4.C

3.2 %

1.9 %

MATCHLINE SEE SHEET #3

3.2 %

1.9 %

9 x 3 x 3
ID 4.B

PC Sta. 19+61.45

EXISTING
PROPERTY
IRON
STA. 19+94

10' GRAVEL
DRIVE

PROPERTY LINE (TYPICAL)

PT Sta. 21+11.57

JIMMY & NANCY
KING
DB 424 PG 387

9 x 3 x 3
ID 4.D

PROPOSED
PIPE
18"x40'
Sta.22+50

MATCHLINE SEE SHEET #5

WILLIAM MILLER
DB 400 PG 149



LOCATION: SR 1195 KING RD.
COUNTY: YADKIN

TOWNSHIP: BUCK SHOALS

DESIGNED BY: J.D.WOOD

CHECKED BY: CSA DATE: 5/28/09

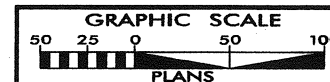

MILDRED BEAUCHAMP ET AL
BD 334 PG 023

RONNIE KING ET UX
DB 424 PG 369

JIMMY & NANCY
KING
DB 424 PG 387

LESTER & SHIRLEY
KING
DB 424 PG 741

18" MIN. WATTLE
HEIGHT

ALL BASIN'S 10'-20'
IN LENGTH REQUIRE
2 COIR FIBER BAFFLES.
BASIN'S LESS THAN 10'
REQUIRE ONLY 1
DESIGN BY: J. C. BRYANT 669

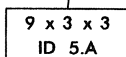
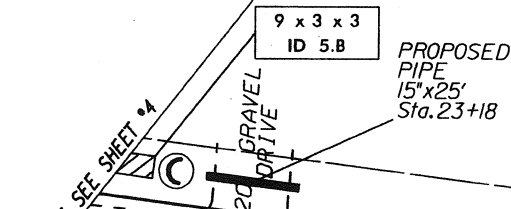

S 64° 38' 48.4" E

1.8 %

1.8 %

EXISTING
PROPERTY
IRON
STA. 24+75

MATCHLINE SEE SHEET #4

MATCHLINE SEE SHEET #6

PROPERTY LINE (TYPICAL)

PROPERTY LINE (TYPICAL)



LOCATION: SR 1195 KING RD.
COUNTY: YADKIN
TOWNSHIP: BUCK SHOALS
DESIGNED BY: J.D. WOOD
CHECKED BY: CSA DATE: 5/28/09

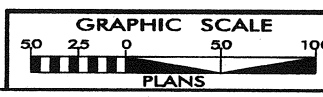

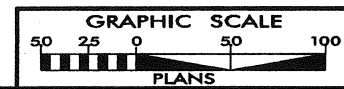
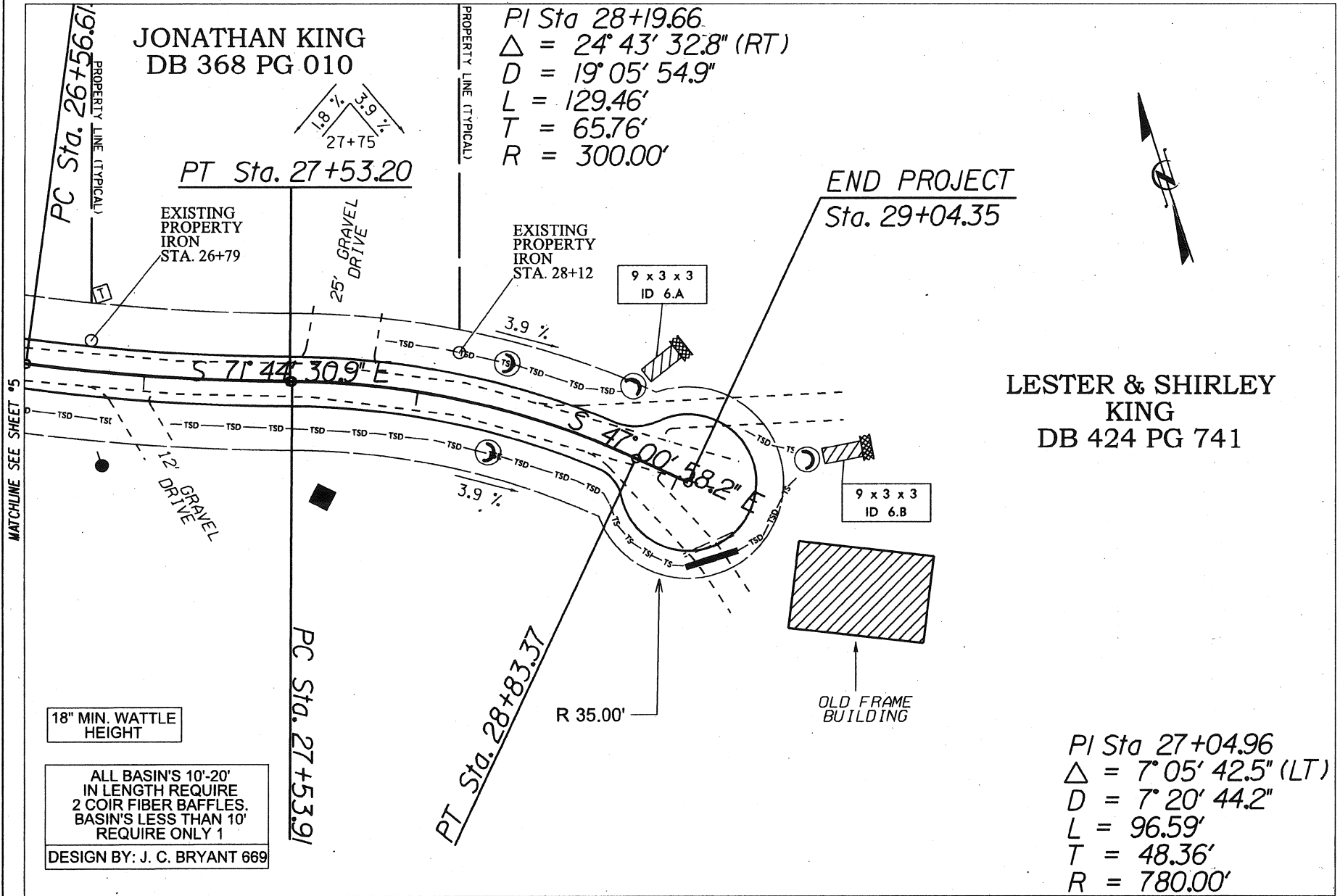

LOCATION: SR 1195 KING RD.
 COUNTY: YADKIN
 TOWNSHIP: BUCK SHOALS
 DESIGNED BY: J.D.WOOD
 CHECKED BY: CSA DATE: 5/28/09

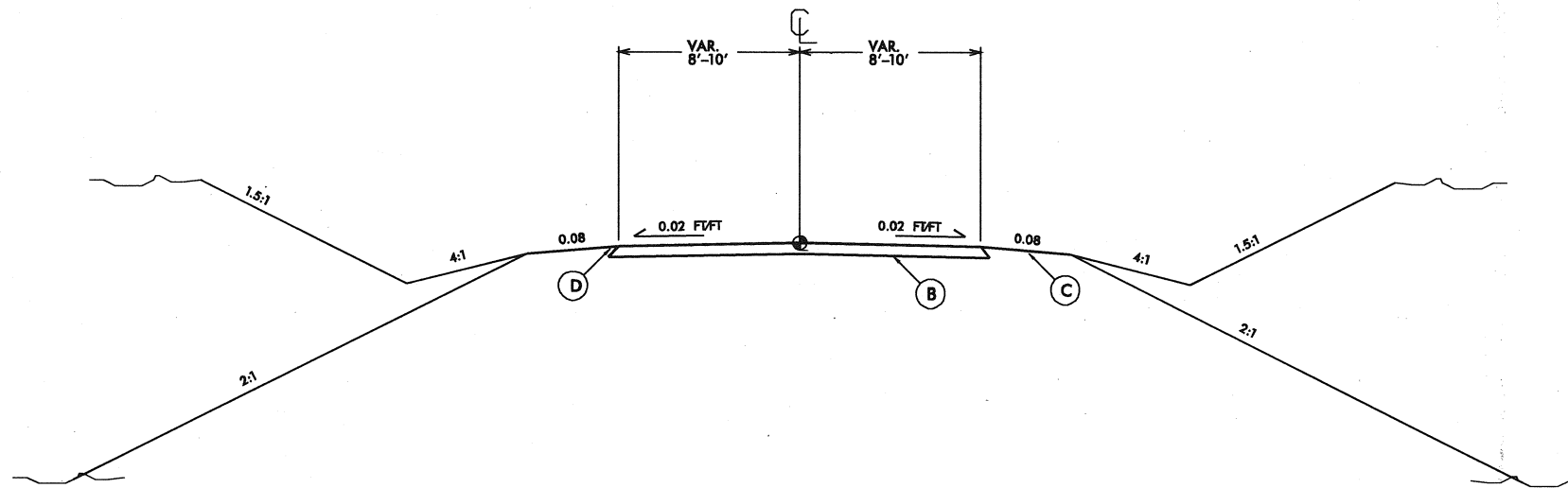

B 8" (compacted) ABC

C Shoulder varies: Cut side = 4' shoulder on .08 ft/ft
 transition to a 4:1 slope for a distance of 4'
 to center of the ditch line
 Fill side = 6' to shoulder break

D Base should be 1' wider than
 overall proposed road width



Temporary Silt Fence



Special Sediment Control Fence



Temporary Silt Ditch



Temporary Diversion



Temporary Slope Drain



Riser Basin



Silt Basin, Type B



Temporary Rock Silt Check, Type A



Temporary Rock Silt Check, Type B



Temporary Rock Sediment Dam, Type A



Temporary Rock Sediment Dam, Type B



Rock Pipe Inlet Sediment Trap, Type A



Rock Pipe Inlet Sediment Trap, Type B

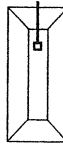

Skimmer Basin



Stilling Basin

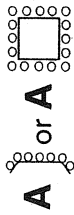

Rock Inlet Sediment Trap, Type A

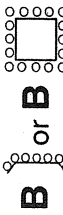

Rock Inlet Sediment Trap, Type B

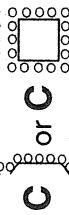

Rock Inlet Sediment Trap, Type C

Coir Fiber Baffle

Gravel Construction Entrance



Special Stilling Basin

Temporary Stream Crossing

without PAM  with PAM 

Wattle with Polyacrylamide (PAM)



Silt Check Type A with Excelsior

Matting and Polyacrylamide (PAM)

FENCE LINE DATA SHEET

ROAD NAME :SR 1195 "KING RD." YADKIN COUNTY

STATION	STATION	RT. / LT.	FUNC. / NONFUNC.	TYPE OF FENCE
20+42	26+79	RT.	FUNCTION	1 STRAND ELECTRIC

Construction Sheet #	2*3	3*4	4	4*5*6	6
Construction Line (-L,-Y-,etc.)	L	L	L	L	L
Left or Right (LT.,RT.,Median)	LT/RT	LT/RT	LT/RT	LT/RT	LT/RT
Upper Station No.	1000	1540	1987	2250	2775
Upper Station Elevation (ft.)	996	1004	989.5	984.5	994
Lower Station No.	1540	1987	2250	2775	2904
Lower Station Elevation (ft.)	1004	989.5	984.5	994	989
Design Ditch Flow Depth (ft.)	0.33	0.33	0.33	0.33	0.33
Actual Ditch Depth (ft.)	1.8	1.8	1.8	1.8	1.8
Frontslope Grade (i.e. 2 for 2:1)	4	4	4	4	4
Backslope Grade (i.e. 2 for 2:1)	2	2	2	2	2
Base Width (ft., 0 for V-Ditches)	0	0	0	0	0
Measured Ditchline Length (ft.)	540	447	263	525	129
Ditch Grade (%)	1.48	3.24	1.9	1.81	3.88
Velocity (ft/s)	2.28	3.38	2.58	2.52	3.69
Shear Stress in Ditch (lb/ft ²)	0.31	0.67	0.39	0.37	0.8
Ditch Liner Requirement	MATTING	MATTING	MATTING	MATTING	MATTING
Matting Quantity (yd ²)	680	565	335	665	165
PSRM Matting Quantity (yd ²)	0	0	0	0	0